

GeoSpatial, Augmented Reality, Virtual Reality & Mobile Technology

Mobile Technology today is an **engineering marvel** and is used for:

1. **Communication** – via calls, skype, email, chat, sms, mms etc
2. **Information** – via Internet, browser, social network, search etc
3. **Computing** – It's power is comparable to a small computer
4. **Location** service – via Global Positioning System (GPS)
5. **Navigation** service – via Mapping, Satellite Image
6. **Entertainment** – via Games, Music, Video etc
7. **Recording** device – for Picture & Video
8. **Image, Audio & Video Processing**,
9. **Business** tool – presentation, schedule
10. **Virtual Reality** – via 3D graphics
11. **Augmented Reality** – 3D & Live Video
12. **GeoSpatial** – 3D, Mapping & Location



Convergence

Of Technology



What if we were to combine 4 different types of technology?

1. Geo-spatial

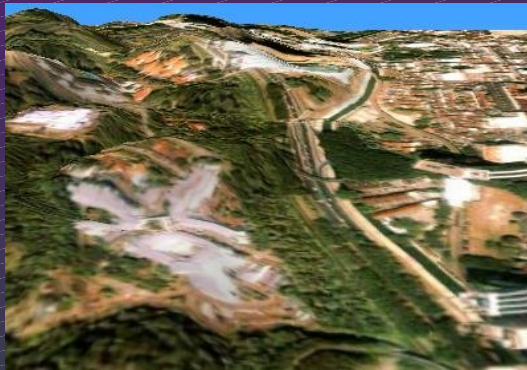

+



2. Augmented Reality

3. Virtual Reality

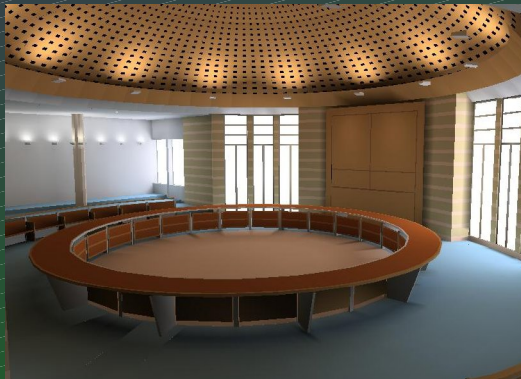

+



4. Mobile Technology

Geo-Spatial, AR, VR & Mobile Technology, Mohd Fazidin Jabar

SuperImposer3D

Introduction



SuperImposer3D is a smartphone application that combines **Geospatial** data, **Virtual Reality**, **Augmented Reality** and **Mobile technology** to view 3D models or to create 3D modelling using the phone as an input device and the **world as the canvas**.

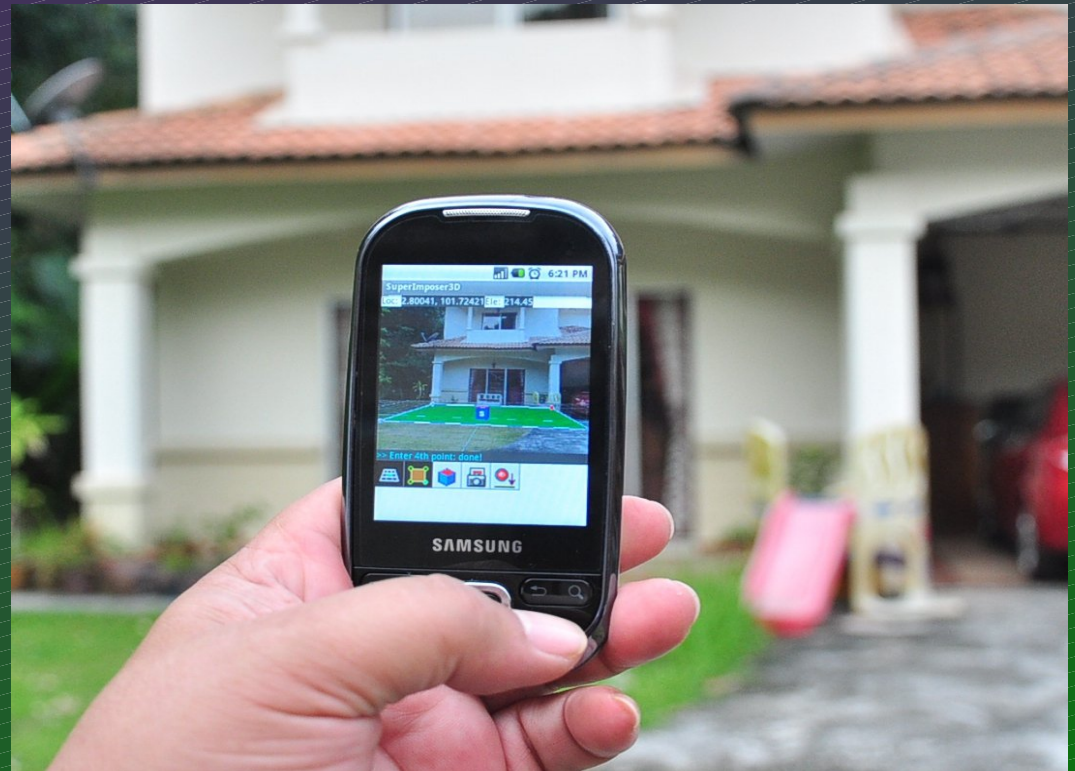
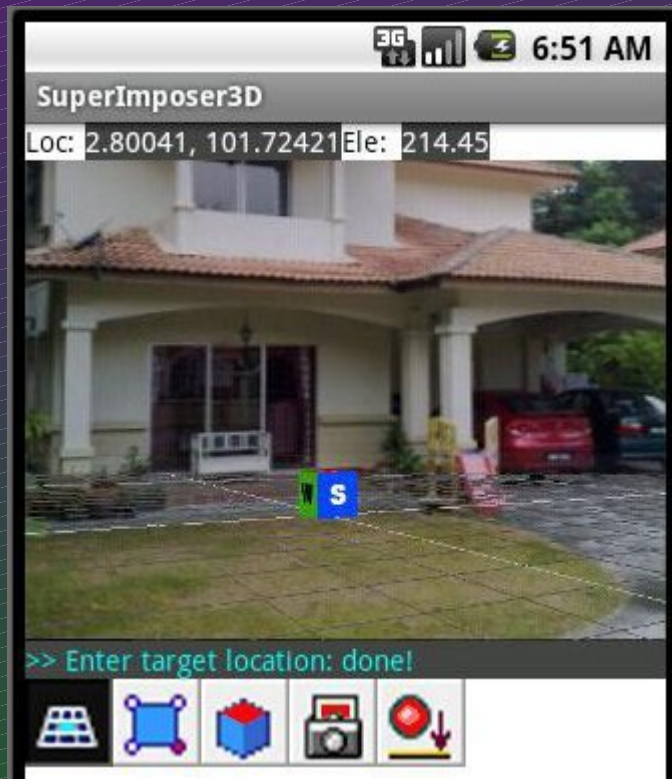

SuperImposer3D

Concept Design



SuperImposer3D uses GPS, geo-tagging camera, satellite link, accelerometer, gyrosensor, compass, 3D modeling, Augmented Reality and Virtual Reality to give the user, the **power to visualize and create** anything they want to build, on any location.

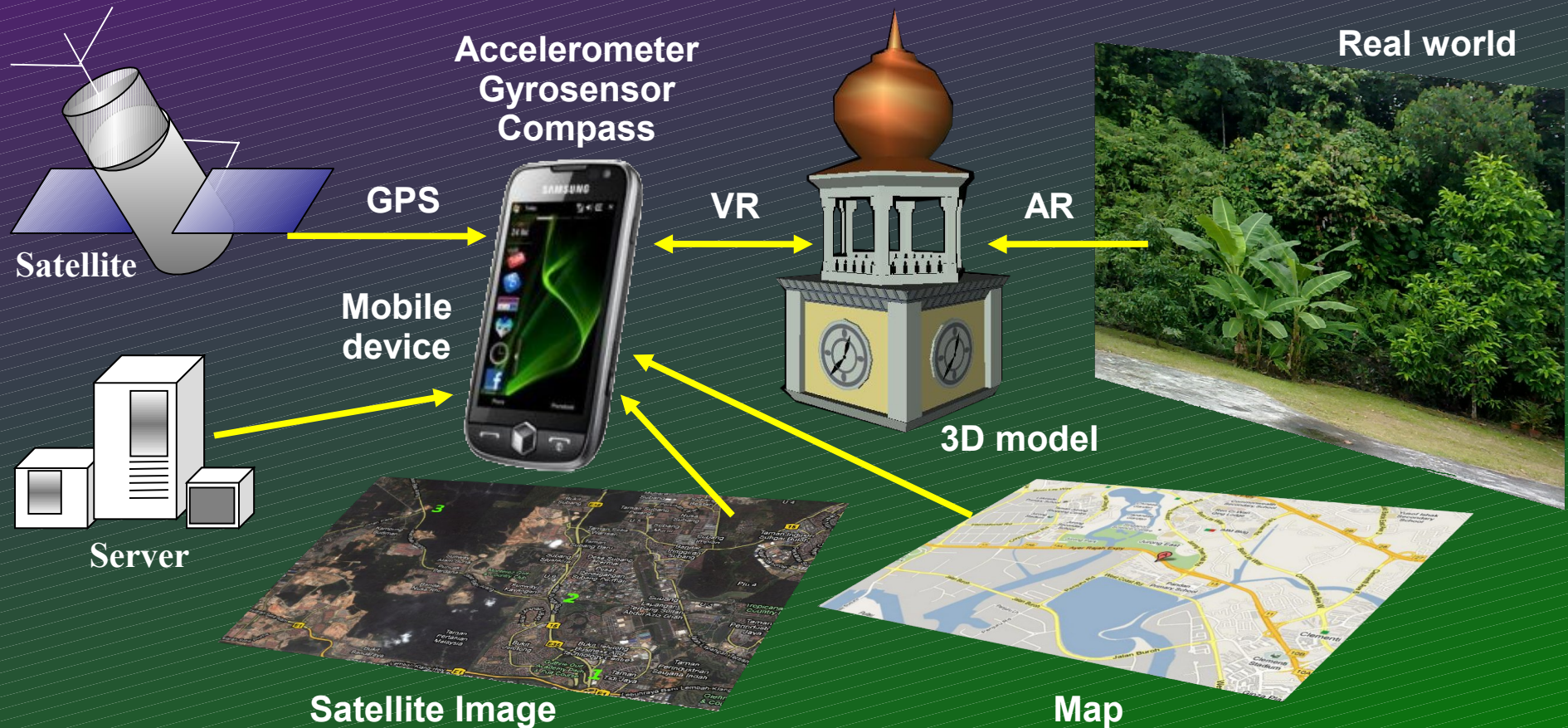

SuperImposer3D

Search & Load 3D models (Off & On Site)



Model Search & Load 3D models via Map or Satellite Image

1. User Anywhere



2. Load Map



3. Put cursor



4. Search models



5. Select model



6. Load Model



7. Interact / Comment



8. Edit / Share



SuperImposer3D

Off-Site 3D model Creation



Model Creation from Off-site via Map or Satellite Image

1. User Off-site



2. Load Map



3. Draw Shape



4. 2D to 3D Edit

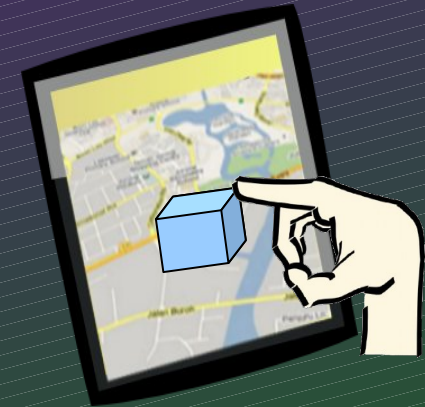

5. Add 3D Detail

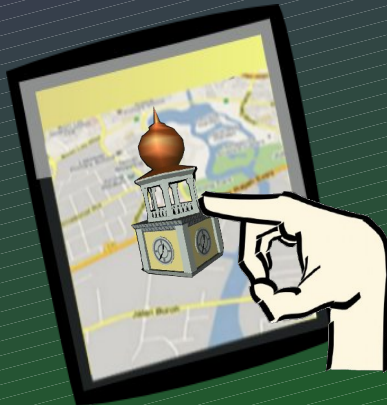

6. Save Model



7. Upload to Server



8. Edit / Share



SuperImposer3D

On-Site 3D model Creation via Live Cam



Model Creation from On-site Location in Augmented Reality

1. User On-site



2. Load Live Cam



3. Set Location

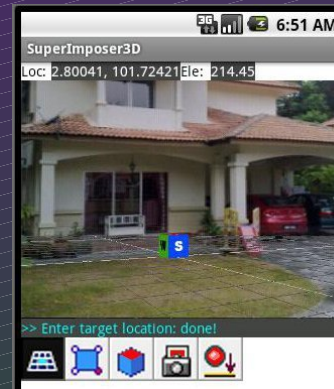

4. Walk & Enter Points

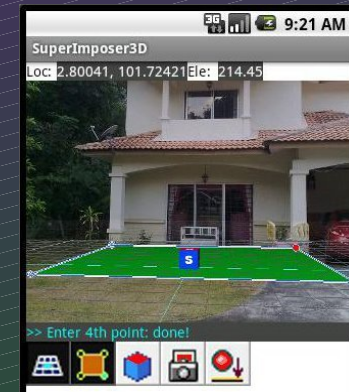

5. 2D to 3D Edit



6. Satellite View

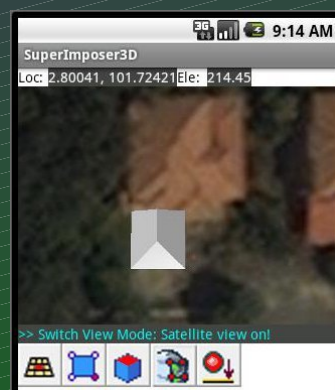

7. Save & Upload



8. Edit / Share



SuperImposer3D

Prototype



Video of SuperImposer3D prototype (version Alpha 0.46)



Thank You

Geo-Spatial, AR, VR & Mobile Technology, Mohd Fazidin Jabar